

## EGing PV EG-P60-C



## About EGing PV

Commitment of EGing PV to continuous improvement in techniques and knowhow for manufacturing ensures the high quality of EGing Modules. They deliver high performance with stable efficiency for wide variety of applications ranging from roof systems of different sizes to large and utility scale solarfarms.

## Features

- » EGing supply chain management expertise makes possible customer tailored module solutions for different systems and applications
- » Product Warranty: 10 years
- » Guaranteed power output: 90% power output in 10 years and 80% in 25 years, calculated from the date of delivery
- » Tested by leading institutes and certified for reliability:
  - » TUV , IEC 61215, IEC 61730
  - » VDE , IEC 61215, IEC 61730
  - » MCS
  - » CE



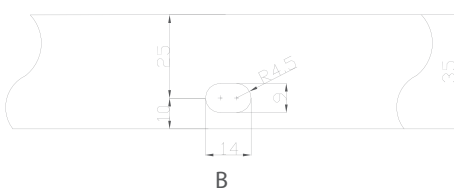
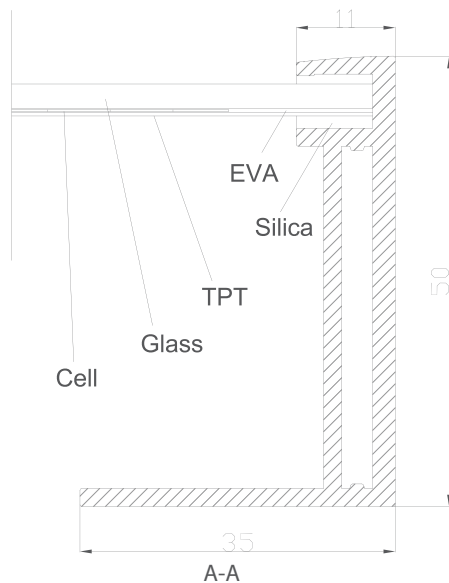
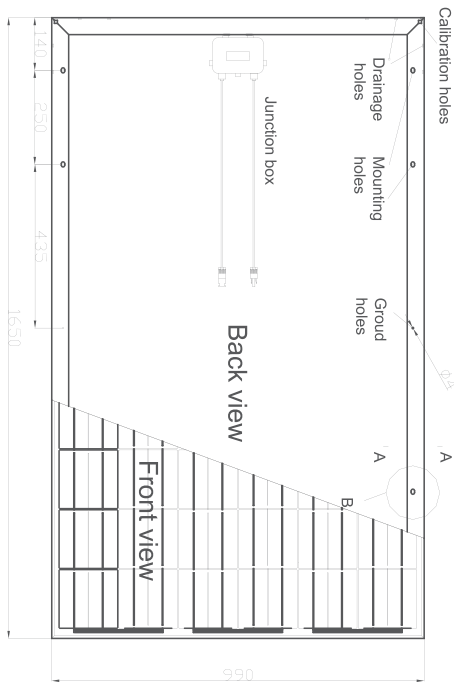

### Electrical characteristics

STC	EG-240P60-C	EG-245P60-C
P <sub>max</sub> (W)	240	245
V <sub>mp</sub> (V)	29.71	29.92
I <sub>mp</sub> (A)	8.08	8.19
V <sub>oc</sub> (V)	37.25	37.47
I <sub>sc</sub> (A)	8.62	8.73
Module efficiency (%)	14.7	15.0
Maximum system voltage (V)	1000	1000
Maximum reverse current (A)	20	20
Power tolerance	0~+3	0~+3
Temperature coefficient P <sub>max</sub> (%/ °C)	-(0.43 ± 0.05)	-(0.43 ± 0.05)
Temperature coefficient I <sub>sc</sub> (%/ °C)	0.04 ± 0.015	0.04 ± 0.015
Temperature coefficient V <sub>oc</sub> (%/ °C)	-(0.325 ± 0.1)	-(0.325 ± 0.1)

STC: irradiance 1000W/m<sup>2</sup>, module temperature 25 °C, AM=1.5

NOCT	EG-240P60-C	EG-245P60-C
P <sub>max</sub> (W)	176.33	180.00
V <sub>mp</sub> (V)	27.10	27.29
I <sub>mp</sub> (A)	6.51	6.60
V <sub>oc</sub> (V)	34.47	34.67
I <sub>sc</sub> (A)	6.99	7.07
Power tolerance	± 3%	± 3%

NOCT: irradiance 800W/m<sup>2</sup>, ambient temperature 20°C, wind speed 1m/s

### Mechanical characteristics

Number of cells (pcs)	60
Size of cell (mm)	156x156
Type of cell	Poly
Thickness of glass (mm)	3.2
Type of frame	Anodized aluminum alloy
Junction box	EG-TL-BOX005B (6-diode), IP65
Size of module (mm)	1650x990x40
Weight (kg)	19.2
Cables/connectors	PV1-F, 4mm <sup>2</sup> , 900mm/MC4 or MC4 compatible

### Maximum ratings

Operating temperature (°C)	-40~85
Operating humidity (%)	5~85
Allowable hail load	25mm ice-ball with velocity of 23m/s

